

LOCKNUT SIZE AND RANGE DATA

Tap Size In Inches	C Width Across Flats			D Overall Thickness		
	Nom.	Max.	Min.	Nom.	Max.	Min.
AUTOMATION GRADE B						
1/4	7/16	0.4375	0.428	1/4	0.257	0.243
5/16	1/2	0.5000	0.489	19/64	0.302	0.292
3/8	9/16	0.5625	0.551	3/8	0.377	0.360
7/16	11/16	0.6875	0.675	27/64	0.430	0.410
1/2	3/4	0.7500	0.736	1/2	0.510	0.490
9/16	7/8	0.8750	0.861	35/64	0.555	0.535
5/8	15/16	0.9375	0.922	41/64	0.645	0.621
3/4	1-1/8	1.1250	1.088	47/64	0.750	0.702
AUTOMATION GRADE C						
1/4	7/16	0.4375	0.428	7/32	0.226	0.212
5/16	1/2	0.5000	0.489	17/64	0.273	0.258
3/8	9/16	0.5625	0.551	21/64	0.337	0.320
7/16	11/16	0.6875	0.675	3/8	0.385	0.365
1/2	3/4	0.7500	0.736	7/16	0.448	0.427
9/16	7/8	0.8750	0.861	31/64	0.496	0.473
5/8	15/16	0.9375	0.922	25/64	0.559	0.535
3/4	1-1/8	1.1250	1.088	41/64	0.665	0.617

AUTOMATION STYLE

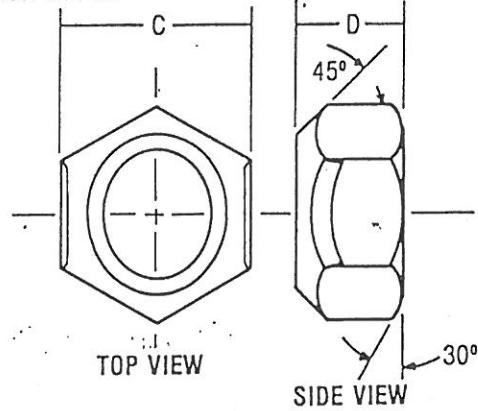

Tap Size In Inches	C Width Across Flats		D Overall Thickness		F Hex Height	
	Max.	Min.	Max.	Min.	Max.	Min.
HEX COLLAR GRADES A & C						
7/8	1.312	1.269	0.776	0.724	0.510	0.490
1	1.500	1.450	0.887	0.831	0.582	0.562
1-1/8	1.687	1.631	0.999	0.939	0.657	0.636
1-1/4	1.875	1.812	1.094	1.030	0.719	0.698
1-3/8	2.062	1.994	1.206	1.138	0.793	0.771
1-1/2	2.250	2.175	1.317	1.245	0.865	0.843
1-3/4	2.625	2.538	1.540	1.460	1.012	0.989
2	3.000	2.900	1.763	1.675	1.158	1.134
THIN HEX COLLAR GRADES A & C						
1/4	0.438	0.428	0.219	0.205	0.131	0.116
5/16	0.500	0.489	0.223	0.208	0.139	0.124
3/8	0.562	0.551	0.227	0.210	0.143	0.128
7/16	0.688	0.675	0.260	0.240	0.165	0.150
1/2	0.750	0.736	0.323	0.302	0.217	0.201
9/16	0.875	0.861	0.324	0.301	0.218	0.201
5/8	0.938	0.922	0.387	0.363	0.259	0.242
3/4	1.125	1.088	0.446	0.398	0.295	0.278
7/8	1.312	1.269	0.510	0.458	0.336	0.318
1	1.500	1.450	0.575	0.519	0.379	0.361
1-1/8	1.688	1.631	0.639	0.579	0.420	0.401
1-1/4	1.875	1.812	0.751	0.687	0.492	0.473
1-3/8	2.062	1.994	0.815	0.747	0.535	0.515
1-1/2	2.250	2.175	0.880	0.808	0.576	0.556

Tap Size In Inches	C Width Across Flats		D Overall Thickness		F Hex Height	
	Max.	Min.	Max.	Min.	Max.	Min.
HEAVY HEX COLLAR GRADES A & C						
1/2	0.875	0.850	0.504	0.464	0.346	0.331
5/8	1.062	1.031	0.631	0.587	0.431	0.412
3/4	1.250	1.212	0.758	0.710	0.516	0.497
7/8	1.438	1.394	0.885	0.833	0.602	0.582
1	1.625	1.575	1.012	0.956	0.686	0.666
1-1/8	1.812	1.756	1.139	1.079	0.772	0.751
1-1/4	2.000	1.938	1.251	1.187	0.847	0.826
1-3/8	2.188	2.119	1.378	1.310	0.932	0.910
1-1/2	2.375	2.300	1.505	1.433	1.017	0.995
1-5/8	2.563	2.481	1.632	1.556	1.103	1.080
1-3/4	2.750	2.662	1.759	1.679	1.185	1.155
1-7/8	2.938	2.844	1.886	1.802	1.273	1.249
2	3.125	3.025	2.013	1.925	1.359	1.335

GRADE B: PROOF STRESS 120,000 PSI, low carbon nut, thicker than Grade A & C, for use with low-carbon and medium carbon steel HEAT TREATED bolts and studs, SAE Grade 5, May be used with SAE Grade 2. For sizes equal to or greater than 7/8", see Hex Collar Style in Grades A & C.

GRADE C: PROOF STRESS 150,000 PSI, medium carbon steel. HEAT TREATED nut for use with heat-treated, higher-carbon and alloy steel bolts and studs, SAE Grades 7 & 8.

LOCKNUT STANDARDS FROM IFI-100/LOCKING ABILITY REQUIREMENTS

Nom. Size	PREVAILING TORQUE Max. In-lb (*Indicates ft-lb). First Installation		BREAKAWAY TORQUE, Minimum In.-lb.							
			1st Removal				5th Removal			
			Grade B		Grade C		Grade B		Grade C	
			HIGHEST READING	LOWEST READING	HIGHEST READING	LOWEST READING	HIGHEST READING	LOWEST READING	HIGHEST READING	LOWEST READING
# 6	6.0	8.0	1.5	0.5	2.0	1.0	1.0	0.5	1.5	0.5
# 8	9.0	12	2.0	1.0	2.5	1.0	1.5	0.5	2.0	1.0
#10	13	17	2.5	1.0	3.5	1.5	2.0	1.0	2.5	1.0
#12	20	27	3.5	1.5	4.5	2	2.5	1.0	3.0	1.5
1/4	30	40	5.0	2.5	6.0	3	3.5	1.5	4.5	2
5/16	60	80	8.0	4	10.5	5	5.5	2.5	7.5	3
3/8	80	110	12	5	16	7.5	8.5	4	11.5	5
7/16	100	135	17	7.5	23	10	12	5	16	7.5
1/2	150	17	22	10	30	15	15	7.5	20	10
9/16	17*	25*	30	15	40	20	21	10	28	12.5
5/8	25*	35*	39	17.5	52	25	27	12.5	36	15
3/4	35*	45*	58	25	78	35	41	20	54	25
7/8	50*	70*	88	40	117	50	62	30	82	40
1	70*	90*	120	60	160	80	84	40	112	50
1-1/8	75*	100*	150	70	200	100	105	50	140	70
1-1/4	85*	110*	188	90	250	120	132	60	176	80
1-3/8	100*	135*	220	110	293	140	154	70	205	100
1-1/2	110*	150*	260	130	346	170	182	90	242	120